

Super-resilient
Double Bond carpet cushion
for heavy work-out areas



DUNLOP
GYMLAY®

High-performance carpet cushion for superior impact protection

Aerobic performers, gymnasts and other indoor sports participants need the protection of a surface that provides maximum levels of shock-absorption with a minimum amount of lateral displacement.

Designed with this in mind, Dunlop Gymlay® is a high-performance re-bonded polyurethane carpet cushion formulated to deliver superior impact protection. Its generous thickness and high-density construction provide long term comfort and support to its users, whilst maximising the life and performance of the carpet.

In addition, the proven Dunlop Double Bond installation system maximises the carpet investment and removes the costly problem of having to re-stretch it as it wrinkles and wears with use. Installation with Dunlop's environmentally friendly water-based adhesives ensures that, once the cushion and carpet are laid in position, they stay bonded for the life of the carpet.

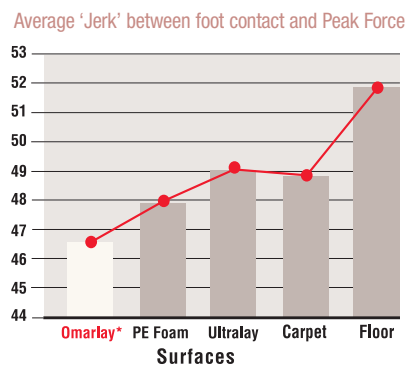

Tests carried out by the Biomechanics Unit of the Victoria University of Technology demonstrated that Gymlay® provided superior shock-absorption. On the key indicators of 'Mean Peak Force' and 'Jerk', Gymlay® in conjunction with the standard carpet was the superior performer. Note that the lower the measurement on the chart, the more effective the product.

*Now marketed as Gymlay®



The unique properties of Dunlop Gymlay® carpet cushion

- Made from 100% recyclable re-bonded polyurethane foam.
- Highly resilient, helping carpet to retain its comfort, shape and appearance for longer.
- Delivers proven impact absorbing performance.
- Provides excellent sound and thermal insulation.
- Exceeds the minimum AS 4288 for breaking force, ensuring sufficient tensile strength for pulling or stretching during installation.
- Has a very low moisture absorption factor, and is generally unaffected by dampness and spills.
- Incorporates Ultra-Fresh, one of the world's leading anti-microbial agents, to inhibit bacterial and fungal growth and protect against germs and allergies.
- CRI Green Label accredited, meeting the highest internationally accepted indoor air quality standards for carpet cushion.
- Australian made.

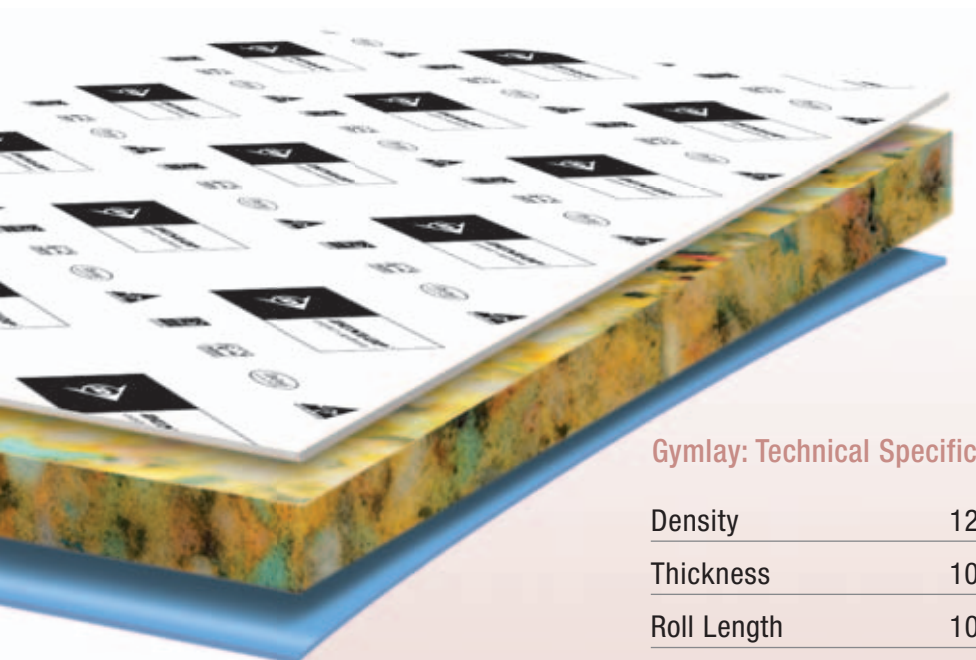

Gymlay: Technical Specifications

Density	120kg/m ³ Nominal
Thickness	10.0mm ± 0.3
Roll Length	10.0m
Roll Width	1800mm ± 5

All statements and technical information contained herein are based on tests we believe to be reliable but the accuracy thereof is not guaranteed. Users assume all risk and liability resulting from the use of this product and must confirm the suitability thereof by their own test. Conditions of Sale contain a limited warranty against manufacturing defects.



DUNLOP
GYMLAY™

Dunlop Gymlay[®]: Double Bond installation system

Double Bond Installation Method Incorporating Dunlop Adhesives

Apply Dunlop Prime & Peel to the subfloor with either a short nap roller or squeegee as illustrated.

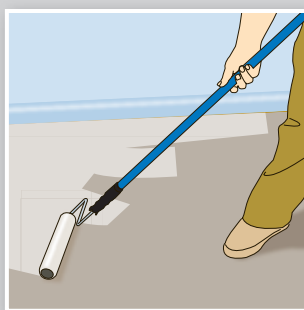

The carpet cushion is lowered onto Dunlop Prime & Peel.

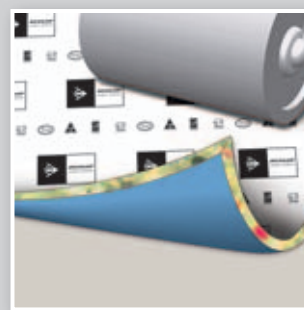

Carpet Cushion Preparation

The cushion should be removed from its plastic packaging and fully unrolled for a period of not less than three hours, or preferably, overnight. The cushion should be laid at 90 degrees to the intended run of the carpet, or if this is not possible, the joins must be offset by a minimum of 300mm.

Any exception to the above should be approved by Dunlop Flooring.

Ventilation

Implement effective ventilation before, during and after installation. Consider mechanical means to bring in fresh air and shorten completed installation curing times.

Surface Preparation

The first critical factor in achieving the desired standard of installation and performance is that the sub-floor must be prepared in accordance with Australian/New Zealand Standard AS/NZS 2455.1:1995 Textile floor coverings – Installation practice Part 1: General, or other approved procedure if one has been specified.

All sub-floor surfaces shall be dry, smooth, plain, sound and clean, free of wax, grease and other contaminants that inhibit adequate adhesion to the sub-floor. The sub-floor must be free from hydrostatic pressure or capillary action. The adhesive should not be used in excessive cold or hot conditions i.e. below 10 degrees C or above 35 degrees C.

Uneven or damaged floors should be repaired with a cementitious levelling compound. All sub-floors should be tested for moisture content prior to surface application of adhesive.

Application of Dunlop Prime & Peel and Cushion

Apply Prime & Peel with a short nap roller and lay the cushion into the Prime & Peel whilst wet, or ensure the adhesive is completely tacked up to a 'touch dry' film. All joins must be close fitting when positioned. A light roller/broom should be used to attain a good transfer.

Note: Overly porous sub-floors may require a double application of Prime & Peel. An overly porous sub-floor can be defined as the top surface of concrete being very open or containing large pores. This sub-floor is highly absorbent, acting as a sponge when adhesives are applied. This absorbent behaviour can affect an acceptable cohesion between cushion and sub-floor. A simple porosity test is to apply several beads of water onto the sub-floor. If the beads of water dissipate almost immediately the sub-floor could be identified as overly porous.

Application of Dunlop Ultrabond and Carpet

Because carpet backings and finishes vary widely (e.g. woven carpets, EVA, anti-static, etc) it is essential that Dunlop Flooring and the suppliers of the selected carpet be consulted for precise installation instructions.

Apply Ultrabond to the carpet cushion's top laminate with a 3.2 x 3.2 x 1.6mm 'V' notched trowel in a continuous "S" sweeping motion. Allow the adhesive to tack up for 10-20 minutes, depending on the atmospheric conditions.

For detailed information on Dunlop Adhesives refer to the Dunlop Adhesives Brochure.

Dunlop Ultrabond is then evenly applied using the specified 'V' notched trowel.

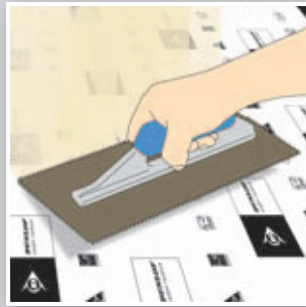

The carpet is lowered onto the adhesive. Ensure all carpet joints are seamed in accordance with the carpet manufacturer's specification. It is mandatory to use hot melt seaming tape.

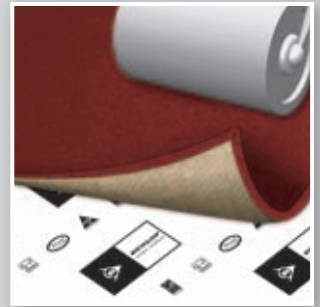

Correct tack up time can be determined by placing a small piece of floor covering into the adhesive. When the floor covering is pulled away, strings of adhesive will be apparent. If no tack or holding power has developed re-check every few minutes. Once the adhesive has tacked up proceed to lower the carpet, ensuring at ALL times good transfer. Roll installation as per the carpet manufacturer's recommendations. Do not allow traffic for 24 hours.

Note 1: It is mandatory to use specially engineered double bond hot melt seaming tapes for ALL Dunlop Double Bond carpet cushions.

Note 2: Shrinkage may occur with certain types of jute backed tufted or woven carpets. Please ensure to adjust installation techniques prior to the commencement of the installation. If the soft floor covering could be prone to shrinkage, Dunlop Flooring recommends consideration of its Secure Fix System.

Note 3: A trowel is a calibrated measuring device and must be carefully chosen and maintained. During use the trowel will wear and clog with adhesive therefore it is good practice to wash and re-file the trowel when necessary to ensure that the correct spread rate of adhesive is achieved throughout the whole installation.

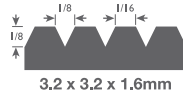

Clean Up

Clean tools and equipment immediately with warm soapy water.

Health Hazard and First Aid

Refer to Material Safety Data Sheets.

Optimising Installation Performance

Dunlop Flooring seeks always to ensure that installation outcomes are of the highest performance quality available. In line with this, Dunlop's range of carpet cushions and adhesives have undergone extensive development and evaluation to ensure their combined use optimises the integrity of the double bond installation.

Dunlop Flooring warrants that the partnership of its carpet cushions and adhesives, and their application according to the instructions as prescribed, will enable the installer to achieve the highest quality result in their double bond installation. In support of this, and the adoption of single source purchasing, Dunlop Flooring will readily provide consultation and technical advice as appropriate.

All statements and technical information contained herein are based on tests we believe to be reliable but the accuracy thereof is not guaranteed. Users assume all risk and liability from the use of this product and must confirm the suitability thereof by their own test. Conditions of Sale contain a limited warranty against manufacturing defects.

Dunlop Secure-Fix Double Bond Installation System

The Dunlop Secure-Fix Double Bond Installation System is an extension of the Dunlop Double Bond Installation System. Secure-Fix incorporates a hot melt seaming tape, and as required architectural gripper fixed at the perimeter.

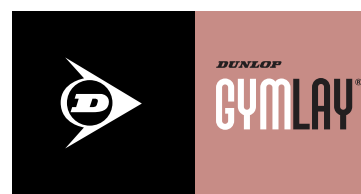

Dunlop Flooring: sticking with an environmentally responsible approach

Dunlop Flooring has long pursued a commitment to environmental sustainability, as well as offering products that improve the health and quality of our work and living spaces. As a leader in environmentally responsible manufacturing and product design, Dunlop is meeting the demands of industry and end-users alike for products that promote a healthier environment – both indoor and out.

Dunlop carpet cushion – recycled and recyclable

Manufactured from 90% post-consumer and post-industrial polyurethane foam off-cuts, Dunlop carpet cushion is itself 100% recyclable, in that it can be reclaimed and re-manufactured into new product.

As well as recycling 98% of its own manufacturing waste, Dunlop is Australia's first manufacturer to introduce a carpet cushion recovery programme, enabling it to retrieve used product to source as raw material.



CRI Green Label accredited for indoor air quality

Dunlop's range of carpet cushion is the first in Australia to be CRI Green Label accredited by the Carpet and Rug Institute in the USA.

The CRI Green Label testing programme identifies products that promote superior indoor air quality and requires that carpet cushion meet strict criteria on the emission of volatile organic compounds (VOCs).

Importantly, it is the benchmark set by the Green Building Council Australia to meet its Green Star rating for building interiors.



Ultra-Fresh – an important step towards a healthier interior environment

Scientific evidence has established that interior environments can be a major contributor to health problems. Dunlop has addressed this important issue by incorporating the proven antimicrobial, Ultra-Fresh, into its carpet cushion to provide effective control of bacteria, mould, mildew and fungi.

Independent research confirms that by inhibiting bacteria and mould and reducing the availability of food for dust mites, Dunlop carpet cushion with Ultra-Fresh helps to control dust mites and may assist in the prevention of asthma and other allergies triggered by them.

Ultra-Fresh also provides lasting hygienic freshness, effective odour protection and extends product life by resisting deterioration.



DUNLOP
GYMLAY™



Dunlop Flooring is a PACIFIC BRANDS Company
For further information contact Customer Service on:

AUS Tel: 1800 622 293 Fax: 1800 634 314

NZ Tel: 09 274 5789 Fax: 09 274 4721

Email: fservice@pacbrands.com.au or visit: www.dunlopflooring.com

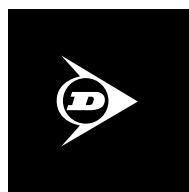

DUNLOP
GYMLAY